

# Performance curves/Technical data

## End-suction centrifugal monoblock pumps

LBI 101H, 1H,  
111H, 11H, 21H

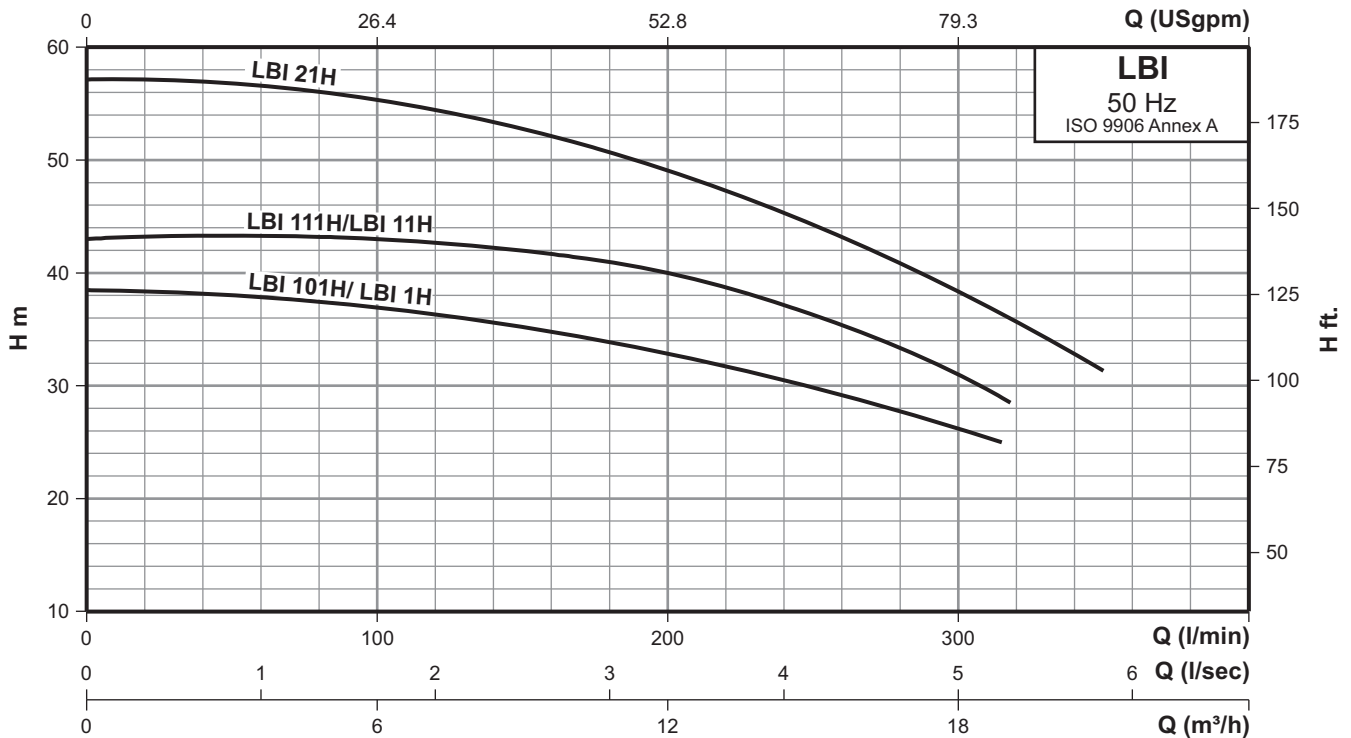

### Performance data at n = 2900 rpm

Model		Power		Q m³/h	6	9	12	15	18	21
Single-phase	Three-phase	[kW]	[HP]							
LBI 101H	LBI 1H	2.20	3.00	H mts.	100	150	200	250	300	350
LBI 111H	LBI 11H	3.70	5.00		37	35	33	30	26	-
-	LBI 21H	5.50	7.50		43	42	40	37	31	-
-	-	-	-	-	55	53	49	44	38	31

### Dimensional sketches

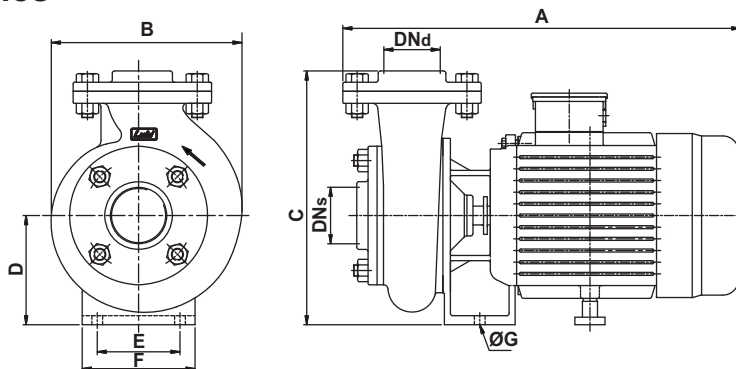

### Dimensions & weights

Model		Power		DNs	DNd	Dimensions [mm]							Gross weight [kg]	Gross volume [m³]
Single-phase	Three-phase	[kW]	[HP]			A	B	C	D	E	F	ØG		
LBI 101H	-	2.20	3.00	2"	1½"	499	245	343	145	145	190	14	86.0	0.162
-	LBI 1H	2.20	3.00	2"	1½"	464	245	343	145	145	190	14	78.0	0.162
LBI 111H	-	3.70	5.00	2"	1½"	499	245	343	145	145	190	14	91.0	0.162
-	LBI 11H	3.70	5.00	2"	1½"	464	245	343	145	145	190	14	83.0	0.162
-	LBI 21H	5.50	7.50	2"	1½"	548	289	375	160	146	200	14	97.0	0.162

Note: All dimensions in mm unless otherwise noted.